

Second Floor Convention	Dimensions	Square Feet	Auditorium	Classroom	Reception	Banquet
Grand Ballroom		49,800	4,034	2,504	4,034	3,025
Rose Ballroom	230x150x24	34,500	2,500	1,750	3,200	1,750
Rose Ballroom A	130x150	19,500	1,500	1,000	1,800	1,000
Rose Ballroom B	100x150	15,000	1,000	750	1,400	750
Junior Ballroom	100x153x18	15,300	1,400	800		900
Ponderosa	153x46x9	7,038	800	400	800	400
Ponderosa A	58x46	2,668	250	120	250	120
Ponderosa B	95x46	4,370	550	250	550	250
Bonanza	140x46x10	6,440	600	300	626	300
Bonanza A	58x46	2,668	280	130	284	130
Bonanza B	46x46	2,116	220	100	225	100
Bonanza C	36x46	1,656	100	70	118	70
Pavilion Area						
Pavilion		24,662			1,900	
Pavilion A		6,670	200	80	400	220
Pavilion B	67x61	4,087	454	175	300	220
Pavilion C	67x56	3,752	417	175	300	220
Pavilion D	67x55	3,685	409	175	300	220
Pavilion E	99x47	4,653	517	325	600	325
Pavilion Foyer/Lobby		8,000				
Meeting Rooms						
Alpine	28x27	756	75	45	60	45
Carson	28x27	756	75	45	60	45
Tahoe	28x27	756	75	45	60	45
Fremont	28x27	756	75	45	60	45
Genoa	65x28	1,804	180	110	200	110
Donner	28x27	756	75	45	60	45
Washoe	33x27	900	80	50	80	50
Truckee	26x13	338	25	18	25	18

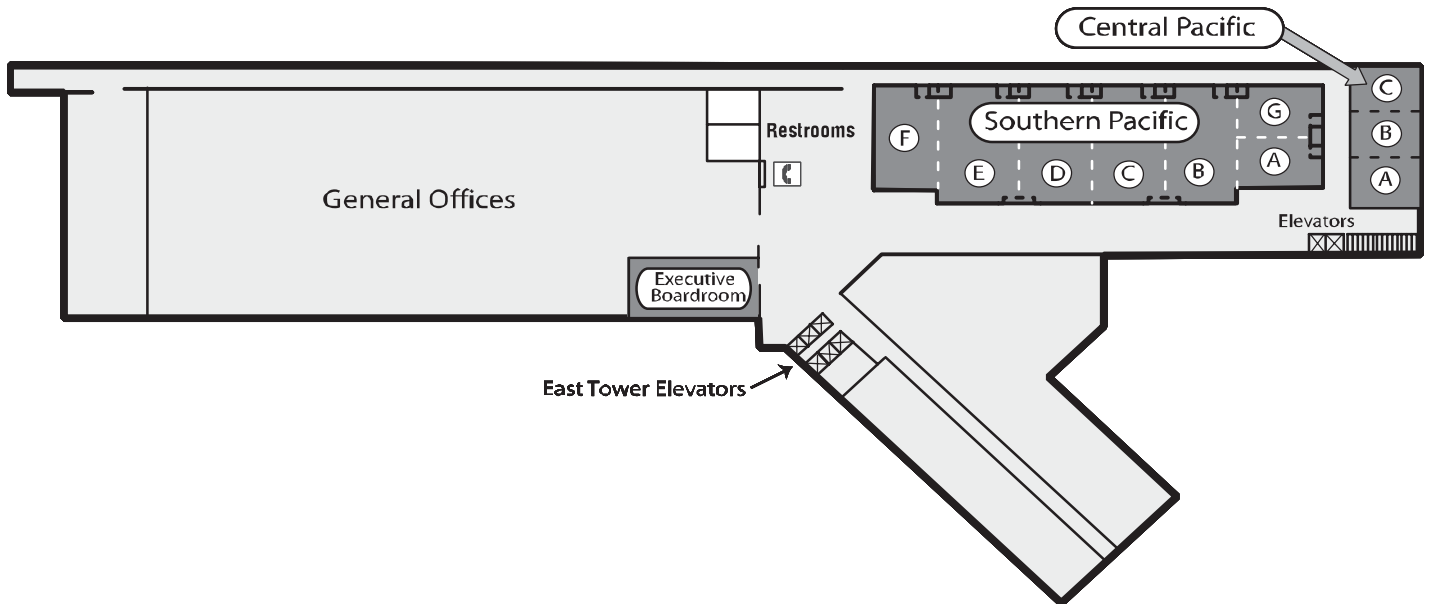

Third Floor Convention	Dimensions	Square Feet	Auditorium	Classroom	Reception	Banquet
Central Pacific	46x22	1,012	100	60	120	60
Central Pacific A	22x18	396	36	24	45	24
Central Pacific B	22x14	308	32	18	35	18
Central Pacific C	22x14	308	32	18	35	18
Southern Pacific	132x35	4,613	508	323	524	360
Southern Pacific A	22x17	374	36	24	40	24
Southern Pacific B	22x36	792	88	55	88	64
Southern Pacific C	22x36	792	88	55	88	64
Southern Pacific D	22x36	792	88	55	88	64
Southern Pacific E	25x36	900	100	62	100	72
Southern Pacific F	22x34	748	72	48	80	48
Southern Pacific G	22x17	374	36	24	40	24
Southern Pacific A/G	22x34	748	72	48	80	48
Executive Boardroom	22x18	400				

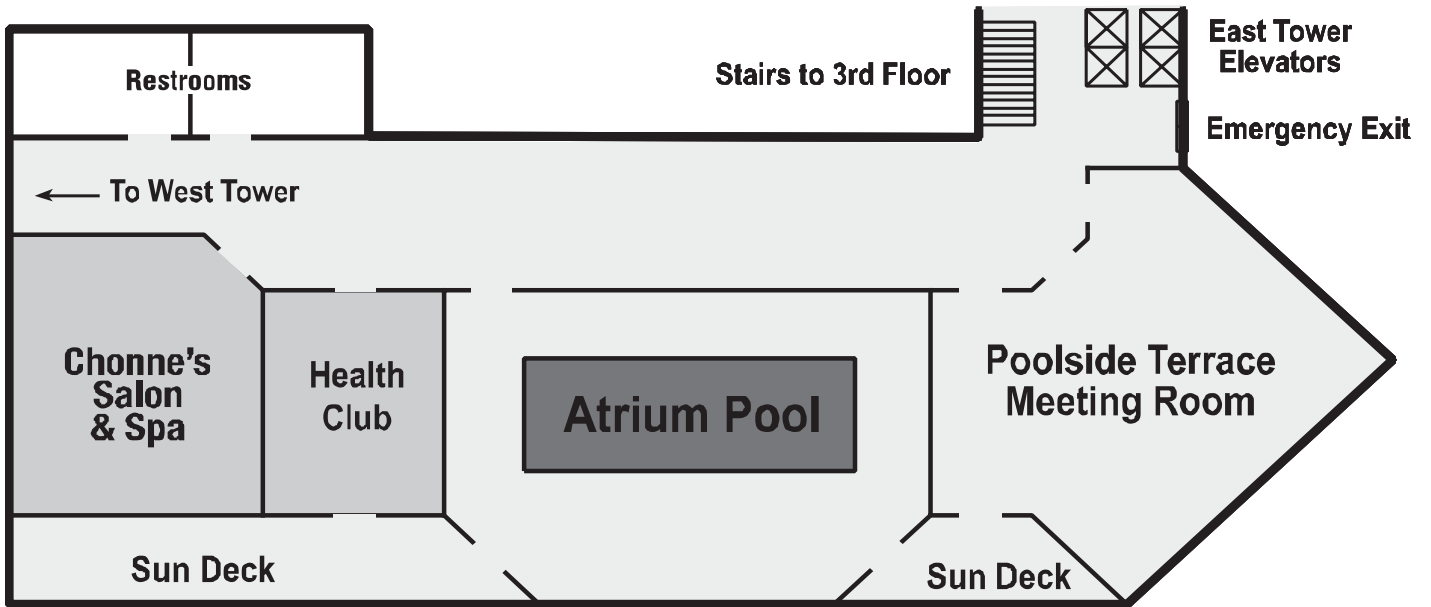

Fifth Floor Convention	Dimensions	Square Feet	Auditorium	Classroom	Reception	Banquet
Poolside Terrace	55x55x12	3,050	350	150	500	250